

ORIGINAL SECTION FILED NOVEMBER 2, 1895
GRADE SECTION 7
AS AMENDED

SCALE: ONE INCH EQUALS 150 FEET

NOTE:
THE ELEVATIONS ON THIS MAP ARE REFERRED TO THE DATUM OF THE BOROUGH OF THE BRONX, 2,608 FEET ABOVE THE U.S. COAST AND GEODETIC SURVEY DATUM AND RELATE TO TOP OF CURB.
THE SIDEWALK WIDTHS SHOWN ON THIS MAP ARE THEORETICAL AND ARE FOR GRADE USE ONLY.

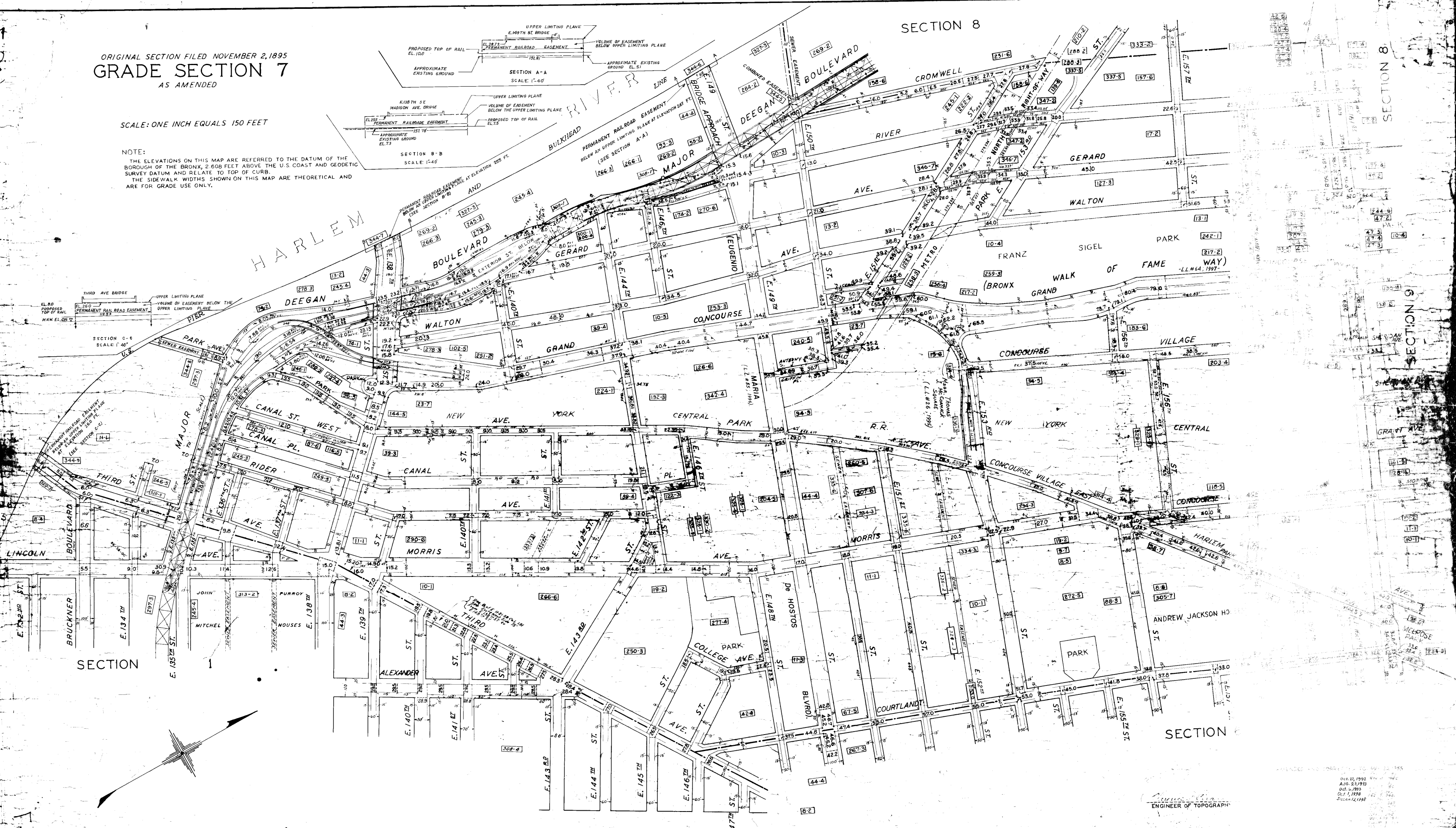
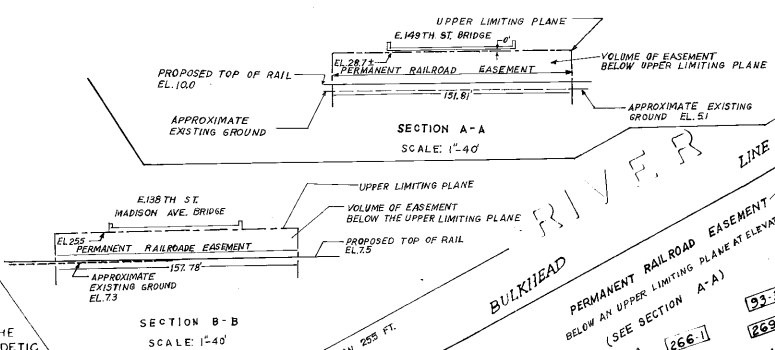

ENGINEER OF TOPOGRAPHY

REVISED AND CORRECTED MAY 22, 1995
Oct. 27, 1992
Aug. 23, 1973
Oct. 9, 1963
Oct. 1, 1958
Dec. 11, 1958