

AMENDED
**FINAL MAP
SECTION 3**

ORIGINAL SECTION FILED JANUARY 19, 1894

NOTE:
THE ELEVATIONS ON THIS MAP ARE REFERRED TO THE DATUM OF THE BOROUGH OF THE BRONX 2.608 FEET ABOVE THE U.S. COAST AND GEODETIC SURVEY DATUM AND RELATE TO TOP OF CURB.
THE SIDEWALK WIDTHS SHOWN ON THIS MAP ARE THEORETICAL AND ARE FOR GRADE USE ONLY.

SCALE: 150 FEET TO 1 INCH

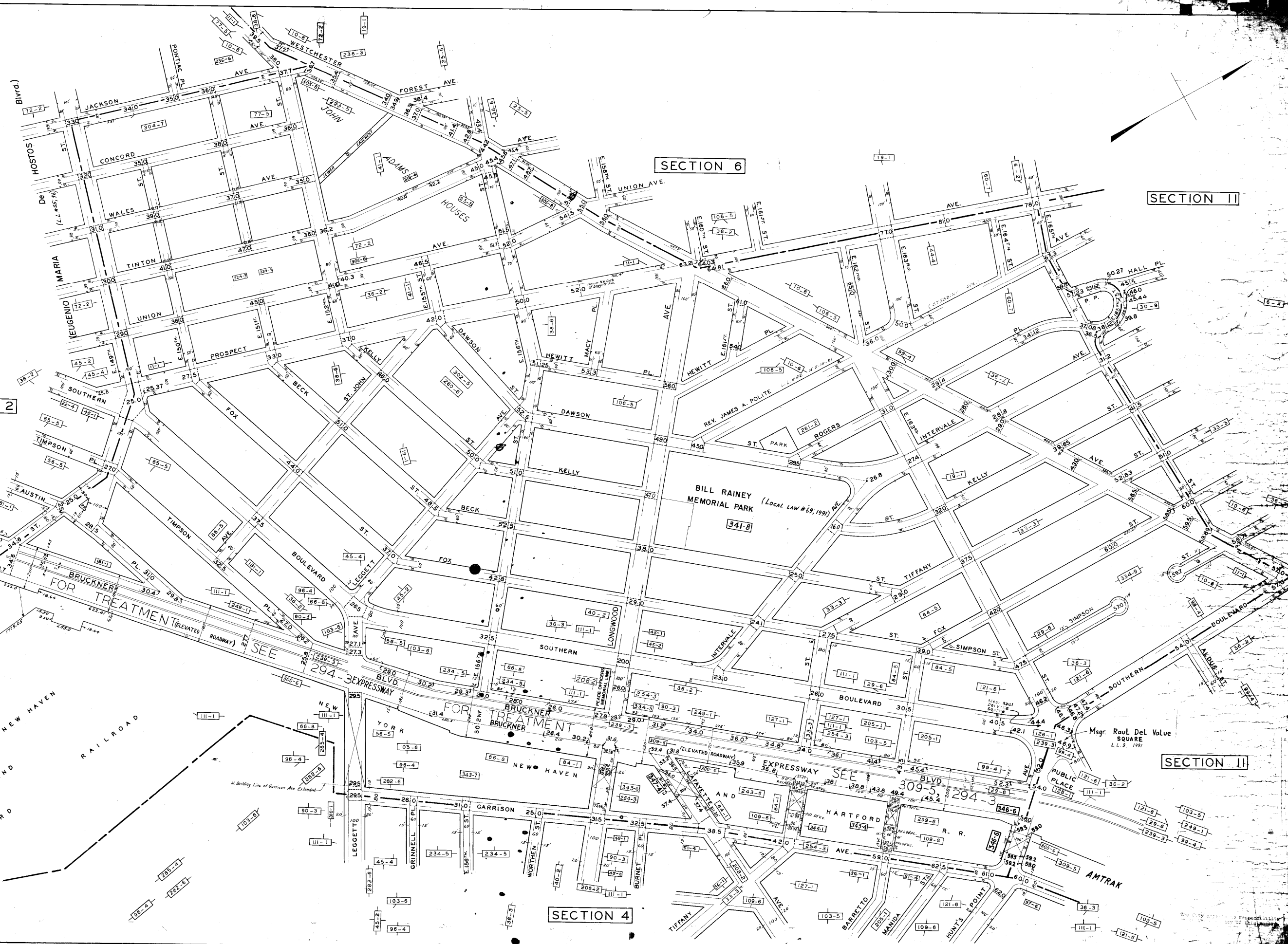

David Schwartz
ENGINEER OF TOPOGRAPHY

- REVISIONS CORRECTED TO:
- 8-28-53
 - 10-5-64
 - 10-29-72
 - 4-18-73
 - 7-15-90
 - 9-22-90
 - 10-19-90
 - 7-30-91
 - 7-08-93
 - 4-05-95
 - 12-21-98
 - 7-15-99
 - 01-31-2000

SECTION 2

SECTION 6

SECTION 11

SECTION 11

SECTION 4

BRUCKNER FOR TREATMENT (ELEVATED ROADWAY)
BRUCKNER BLVD
DE HOSTOS BLVD
EUGENIO MARIA (L.L.#55,194)
NEW YORK AND HARTFORD RAILROAD
NEW HAVEN
YORK
NEW HAVEN
GARRISON
WORTHEN
GRINNELL
LEGGETT
TIPSON
SOUTHERN
BOULEVARD
LEGGETT
NEW HAVEN
GARRISON
WORTHEN
GRINNELL
LEGGETT

BILL RAINEY MEMORIAL PARK (Local Law #69, 1991)

Msr. Raul Del. Value SQUARE L.L. 3, 1991

AMTRAK